

CLERK'S OFFICE

APPROVED

Date: 12-15-98

Submitted by: Chairman of the Assembly at
the Request of the Mayor
Prepared by: Department of Community
Planning and Development
For reading: November 24, 1998

Anchorage, Alaska
AO 98- 185

AN ORDINANCE AMENDING THE ZONING MAP AND PROVIDING FOR THE
REZONING FROM R-1SL (SINGLE-FAMILY RESIDENTIAL WITH SPECIAL
LIMITATIONS) TO PLI (PUBLIC LANDS AND INSTITUTIONS) FOR TRACT A,
MOOSE MEADOWS SUBDIVISION, GENERALLY LOCATED ON THE NORTH SIDE
OF HUFFMAN ROAD AND EAST OF NEW SEWARD HIGHWAY

(Huffman-O'Malley Community Council) (Planning and Zoning Commission Case 98-130)

THE ANCHORAGE ASSEMBLY ORDAINS:

Section 1. The zoning map shall be amended by designating the following described
property as PLI (Public Land and Institutions District) zone:

Tract A, Moose Meadows Subdivision, as shown on Exhibit A attached (Planning
and Zoning Commission Case 98-130).

Section 2. The Director of Community Planning and Development shall change the
zoning map accordingly.

Section 3. This ordinance shall become effective immediately upon passage and
approval by the Anchorage Assembly.

PASSED AND APPROVED by the Anchorage Assembly this 15th day of
December, 1998

ATTEST:

Fay Von Henniger
Chairman

Lizanne Ferguson
Municipal Clerk

(98-130)
(016-191-40)

AM 1100-98

98-130 REZONING

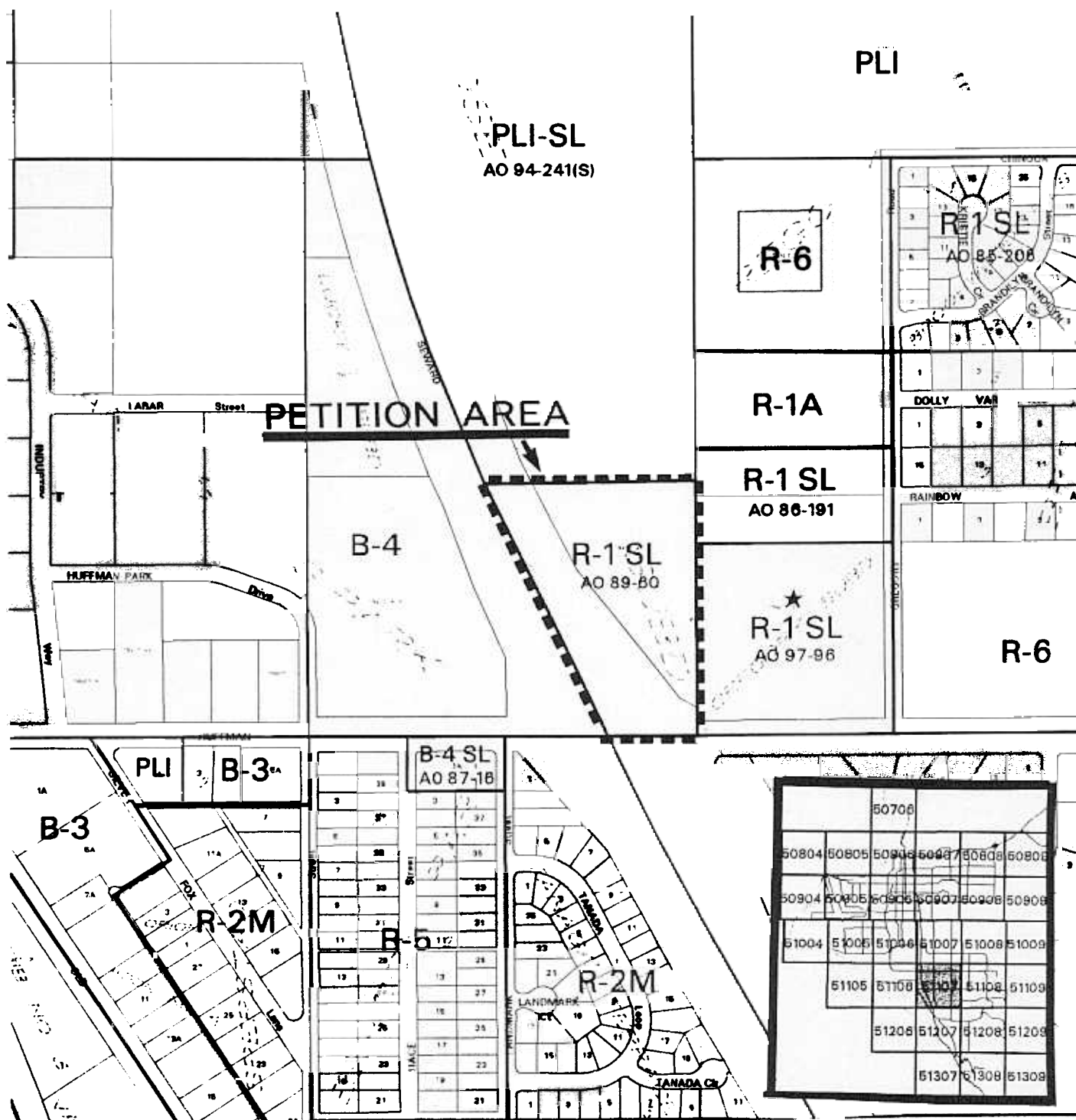

EXHIBIT A



0 500 1000
FEET